

CABLE TIE

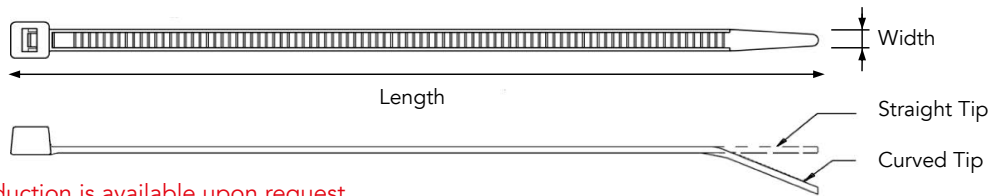

Different colour production is available upon request.

Part No.	Width (mm)	Length (mm)	Max. Bundle Dia (mm)	Min. Tensile Strength (kg)	Box Size (cm)	Pack. Qty. (Bag)	Box Weight (kg)	Packaging Qty. (Ctn)
EB.02.202	2,5	100	22	12	60 x 40 x 40	1.000	23	80.000
EB.12.212	2,5	140	35	12	60 x 40 x 40	100	24	50.000
EB.13.213	2,5	200	54	12	60 x 40 x 40	100	24	35.000
EB.23.223	3,6	100	21	18	60 x 40 x 40	250	25	50.000
EB.03.203	3,6	150	36	18	60 x 40 x 40	100	24	30.000
EB.04.204	3,6	205	54	18	60 x 40 x 40	100	30	25.000
EB.09.209	3,6	250	68	18	60 x 40 x 40	100	29	22.500
EB.10.210	3,6	300	81	18	60 x 40 x 40	100	29	17.500
EB.11.211	3,6	370	102	18	60 x 40 x 40	100	32	16.000
EB.14.214	4,8	200	50	25	60 x 40 x 40	100	28	17.000
EB.06.206	4,8	250	63	25	60 x 40 x 40	100	30	15.000
EB.05.205	4,8	300	80	25	60 x 40 x 40	100	28	15.000
EB.25.225	4,8	350	98	25	60 x 40 x 40	100	32	12.000
EB.16.216	4,8	400	109	25	60 x 40 x 40	100	31	10.000
EB.26.225	4,8	450	125	25	60 x 40 x 40	100	38	9.000
EB.07.207	8	250	62	55	60 x 40 x 40	100	30	8.000
EB.18.218	8	300	75	55	60 x 40 x 40	100	29	6.000
EB.19.219	8	380	105	55	60 x 40 x 40	100	31	6.000
EB.21.221	8	450	124	55	60 x 40 x 40	100	36	4.500
EB.15.215	8	550	160	55	60 x 40 x 40	100	37	4.000
EB.24.224	8	750	220	55	85 x 35 x 24	100	26	2.000
EB.17.217	9	762	225	80	85 x 35 x 24	100	23	1.500
EB.22.222	9	940	290	80	105x35x24	100	29	1.500

CABLE TIE MOUNTS (SELF ADHESIVE & SCREWED)



Part No.	a (mm)	b (mm)	Mount. Hole Dia (mm)	Max. Tie Width (mm)	Packaging Qty. (Bag)	Packaging Qty. (Ctn.)
PK.01.1001	20	20	Ø 3,2	3,6	100	25.000
PK.03.1003	28	28	Ø 4,3	4,8	100	12.500

SCREWED TIE MOUNTS

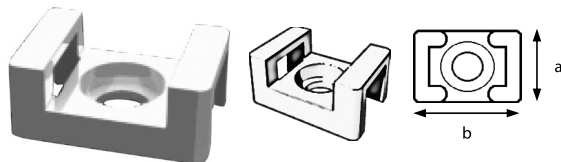

Part No.	a (mm)	b (mm)	Mount. Hole Dia (mm)	Max. Tie Width (mm)	Packaging Qty. (Bag)	Packaging Qty. (Ctn.)
EK.06.1006	10	17	Ø 3,7	4,8	250	40.000
EK.02.1002	17	23	Ø 6,5	8	250	15.000

CABLE TIE MARKER

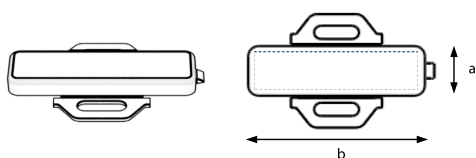

Part No.	a (mm)	b (mm)	Mount. Area		Max. Tie Width (mm)	Packaging Qty. (Bag)	Packaging Qty. (Ctn.)
			Width (mm)	Length (mm)			
ET.07.907	10	35	7	32	8	100	12.500
ET.06.906	20	45	17	42	8	100	6.000

CONCRETE CROCKET

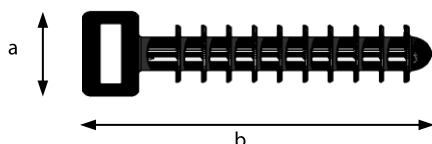

Part No.	a (mm)	b (mm)	Mount. Hole Dia (mm)	Max. Tie Width (mm)	Packaging Qty. (Bag)	Packaging Qty. (Ctn.)
EK.17.1017	13,2	42,8	Ø 8	8	250	12.500